

LEGEND:

	PROPOSED DEVELOPMENT		PROPOSED VERGE		EXISTING CULVERT & NEW PARAPETS
	FENCE		ACCESS TRACK		PROPOSED CULVERTS & PARAPETS
	GATE		WARNING SURFACE TREATMENT		WATERCOURSE/DRAINAGE DITCH
	BOLLARD		TACTILE BLISTERS		NEW / SUPPLEMENTARY PLANTING: (AS SET OUT IN CHAPTER 8 BIODIVERSITY)
	REFUSE BIN		EXISTING VEGETATION		
	PROPOSED GREENWAY PAVEMENT				



ROUGHAN & O'DONOVAN CONSULTING ENGINEERS

Offices:
 Dublin - Sandford & Santry
 Leeds - Otley
 Ireland t +353 (0) 1 294 0800
 UK t +44 (0) 113 360 1720

Project Title	WEST CLARE RAILWAY GREENWAY SECTION 1: KILRUSH TO KILKEE	
ENVIRONMENTAL IMPACT ASSESSMENT REPORT		

Drawing Title: PROPOSED GREENWAY LAYOUT SHEET 20 OF 45		
Drawn: LA	File:	Status: E.I.A.R.
Designed: MCR	Job No: 21.121	Drawing No: Fig 4.21
Checked: DN	Scale: 1:10,000	Rev: P0
Approved: EOC	Date: April 2026	

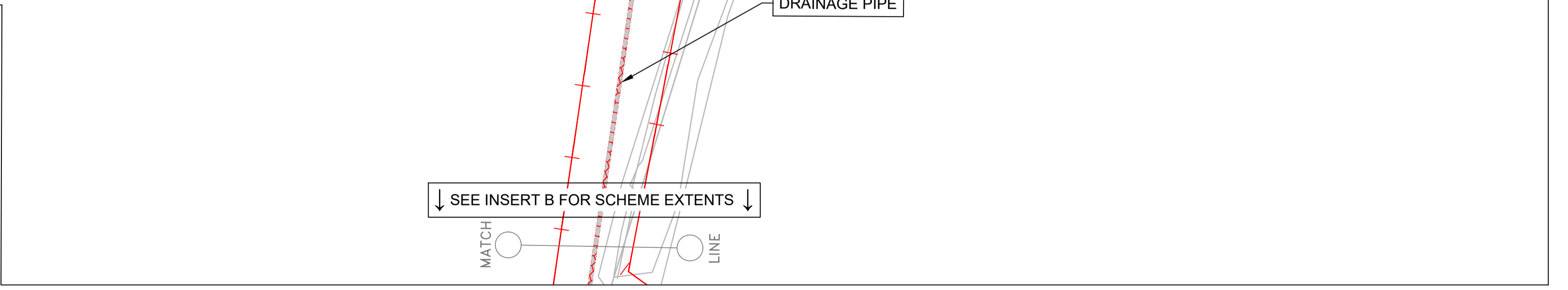
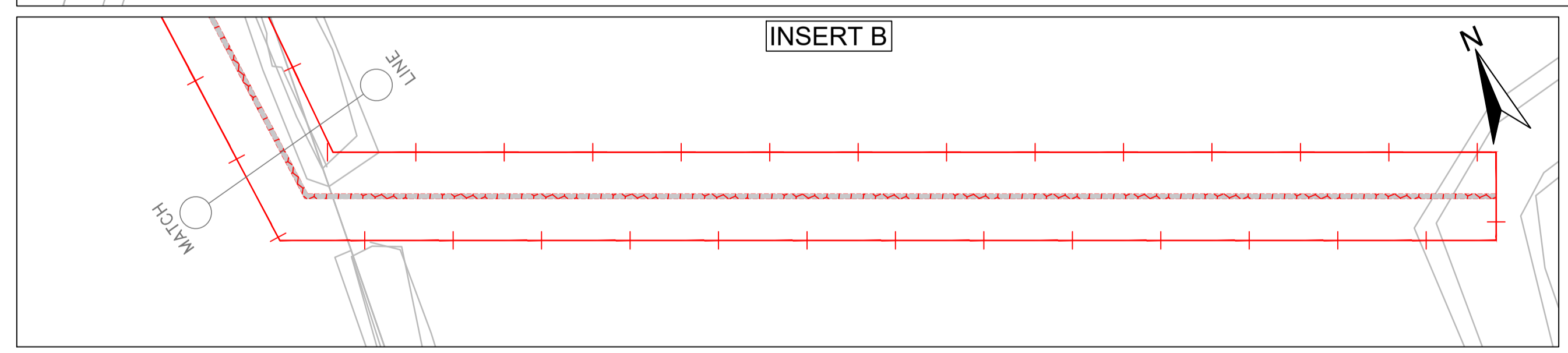
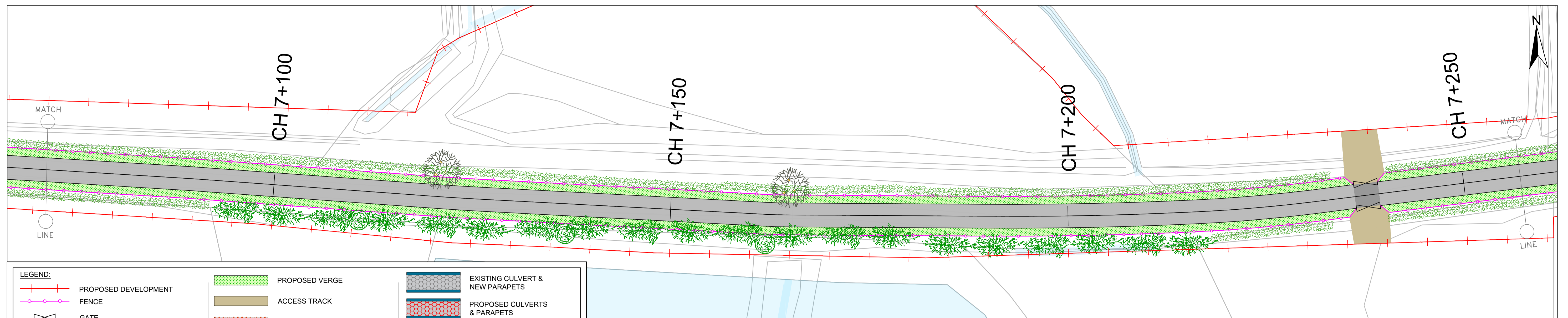

ROUGHAN & O'DONOVAN
CONSULTING ENGINEERS

Offices:
Dublin - Sandford & Santry
Leeds - Otey
Ireland t +353 (0) 1 294 0800
UK t +44 (0) 113 360 1720

Project Title	WEST CLARE RAILWAY GREENWAY SECTION 1: KILRUSH TO KILKEE	
	ENVIRONMENTAL IMPACT ASSESSMENT REPORT	

Drawing Title: PROPOSED GREENWAY LAYOUT SHEET 21 OF 45			
Drawn: LA	File:	Status: E.I.A.R.	
Designed: MCR	Job No: 21.121		
Checked: DN	Scale: 1:10,000	Drawing No: Fig 4.22	Rev: P0
Approved: EOC	Date: April 2026		

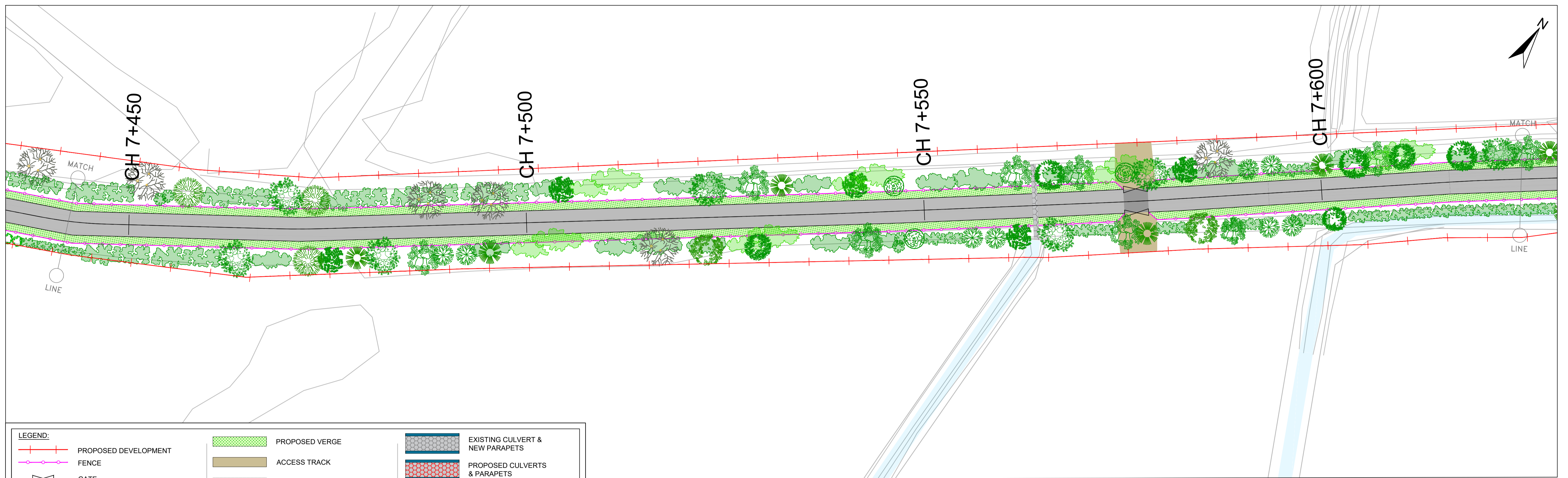

LEGEND:

	PROPOSED DEVELOPMENT		PROPOSED VERGE		EXISTING CULVERT & NEW PARAPETS
	FENCE		ACCESS TRACK		PROPOSED CULVERTS & PARAPETS
	GATE		WARNING SURFACE TREATMENT		WATERCOURSE/DRAINAGE DITCH
	BOLLARD		TACTILE BLISTERS		NEW / SUPPLEMENTARY PLANTING: (AS SET OUT IN CHAPTER 8 BIODIVERSITY)
	REFUSE BIN		EXISTING VEGETATION		
	PROPOSED GREENWAY PAVEMENT				



ROUGHAN & O' DONOVAN
CONSULTING ENGINEERS

Offices:
 Dublin - Sandford & Santry
 Leeds - Otley
 Ireland t +353 (0) 1 294 0800
 UK t +44 (0) 113 360 1720

Project Title	WEST CLARE RAILWAY GREENWAY SECTION 1: KILRUSH TO KILKEE	
	ENVIRONMENTAL IMPACT ASSESSMENT REPORT	

Drawing Title: PROPOSED GREENWAY LAYOUT SHEET 22 OF 45			
Drawn: LA	File:	Status: E.I.A.R.	
Designed: MCR	Job No: 21.121		
Checked: DN	Scale: 1:10,000	Drawing No: Fig 4.23	Rev: P0
Approved: EOC	Date: April 2026		

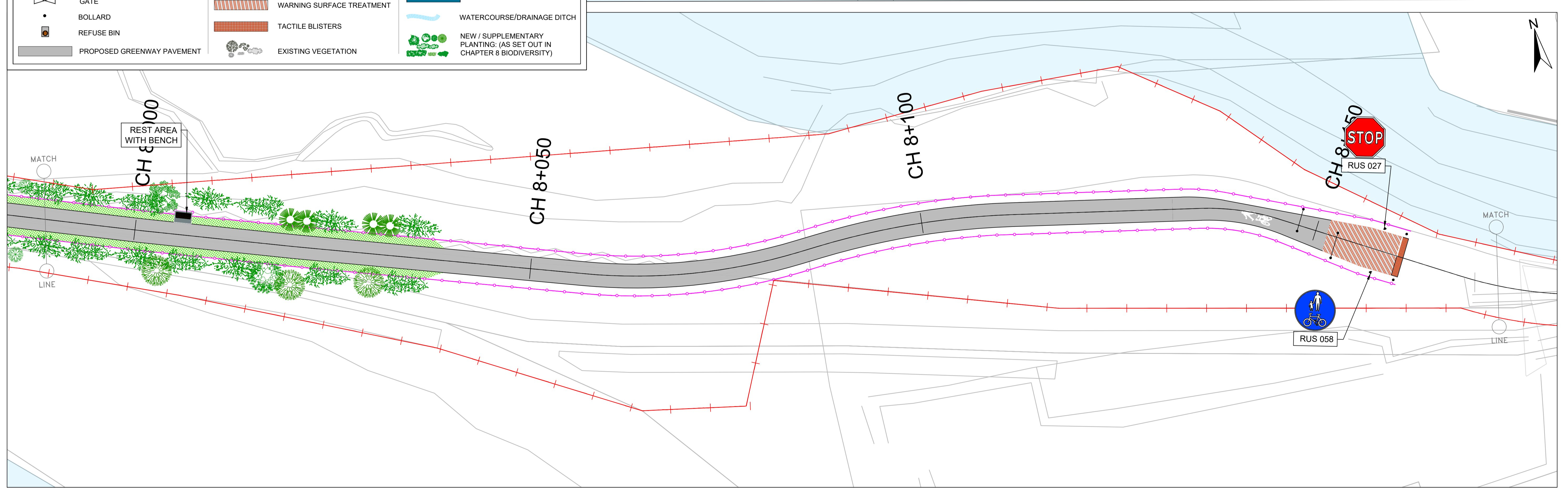
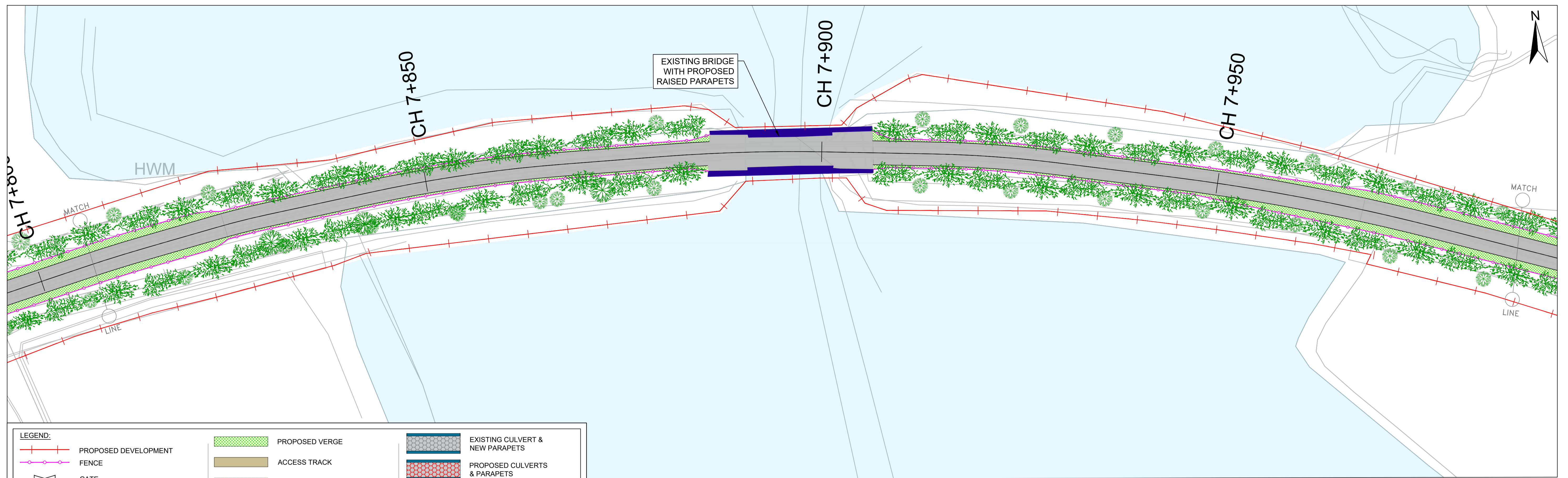

LEGEND:

	PROPOSED DEVELOPMENT		PROPOSED VERGE		EXISTING CULVERT & NEW PARAPETS
	FENCE		ACCESS TRACK		PROPOSED CULVERTS & PARAPETS
	GATE		WARNING SURFACE TREATMENT		WATERCOURSE/DRAINAGE DITCH
	BOLLARD		TACTILE BLISTERS		NEW / SUPPLEMENTARY PLANTING: (AS SET OUT IN CHAPTER 8 BIODIVERSITY)
	REFUSE BIN		EXISTING VEGETATION		
	PROPOSED GREENWAY PAVEMENT				



ROUGHAN & O'DONOVAN
CONSULTING ENGINEERS

Offices:
Dublin - Sandford & Santry
Leeds - Otley
Ireland t +353 (0) 1 294 0800
UK t +44 (0) 113 360 1720

Project Title
**WEST CLARE RAILWAY GREENWAY
SECTION 1: KILRUSH TO KILKEE**

ENVIRONMENTAL IMPACT ASSESSMENT REPORT

Drawing Title:
**PROPOSED GREENWAY LAYOUT
SHEET 23 OF 45**

Drawn: LA	File:	Status: E.I.A.R.
Designed: MCR	Job No: 21.121	Drawing No: Fig 4.24
Checked: DN	Scale: 1:10,000	Rev: P0
Approved: EOC	Date: April 2026	

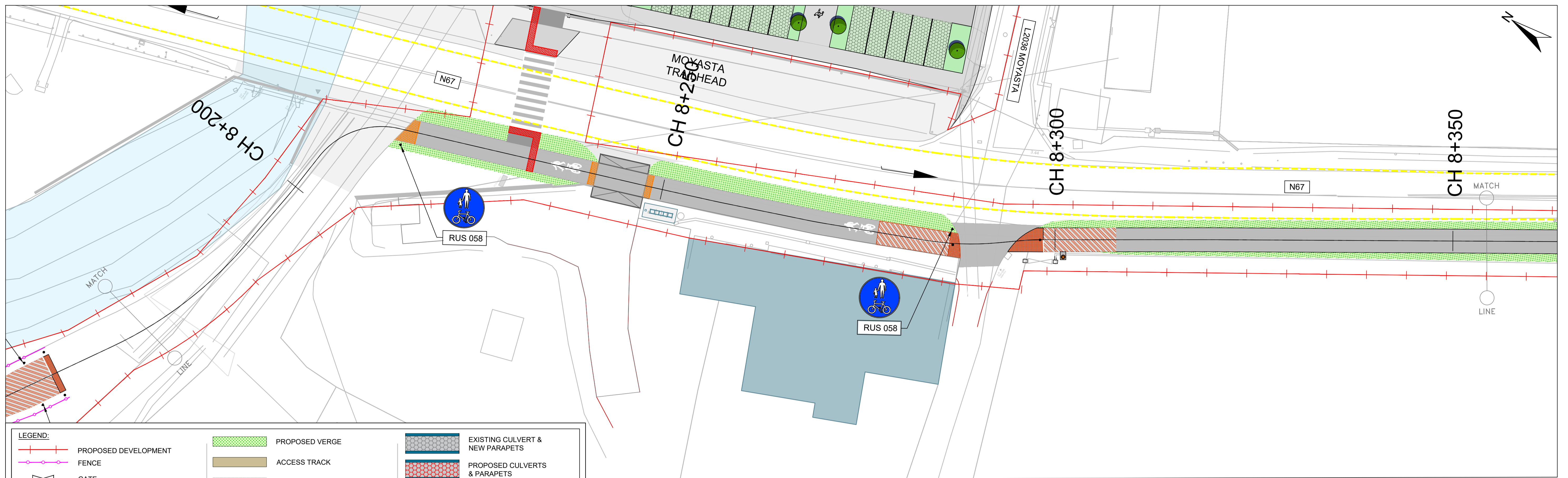

LEGEND:

	PROPOSED DEVELOPMENT		PROPOSED VERGE		EXISTING CULVERT & NEW PARAPETS
	FENCE		ACCESS TRACK		PROPOSED CULVERTS & PARAPETS
	GATE		WARNING SURFACE TREATMENT		WATERCOURSE/DRAINAGE DITCH
	BOLLARD		TACTILE BLISTERS		NEW / SUPPLEMENTARY PLANTING: (AS SET OUT IN CHAPTER 8 BIODIVERSITY)
	REFUSE BIN		EXISTING VEGETATION		
	PROPOSED GREENWAY PAVEMENT				

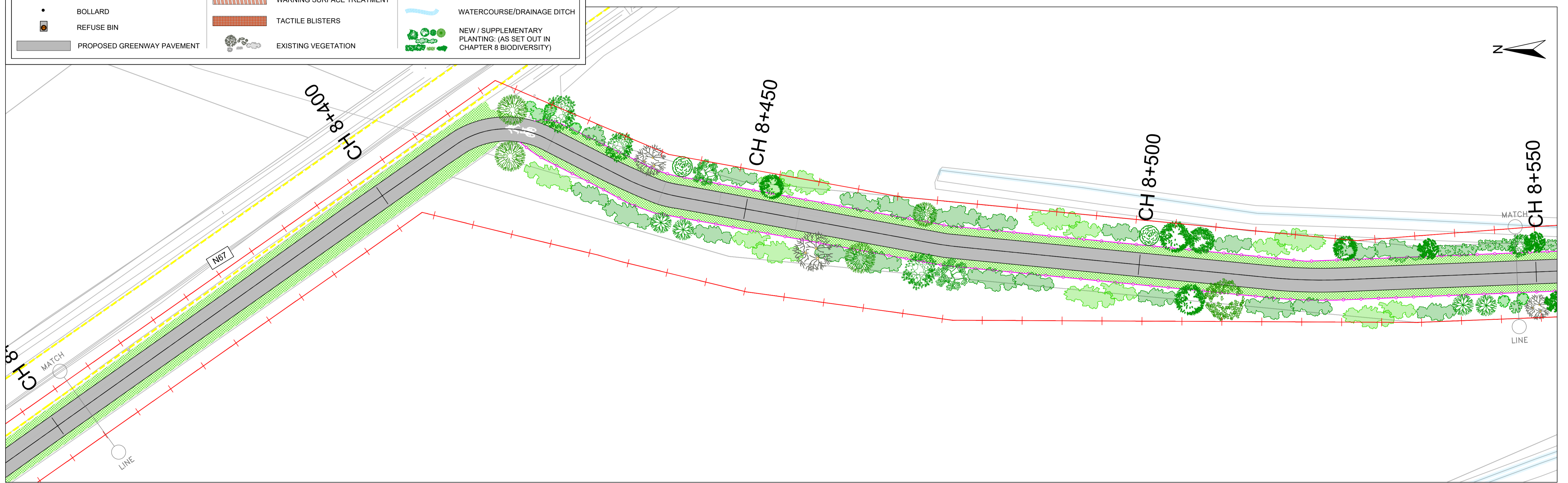

<p>COMHAIRLE CONTAE AN CHLÁIR CLARE COUNTY COUNCIL</p>	<p>Tionscatal Éireann Project Ireland 2040</p>	<p>Bonneagar Iompair Éireann Transport Infrastructure Ireland</p>	<p>ROUGHAN & O'DONOVAN CONSULTING ENGINEERS</p> <p>Offices: Dublin - Sandford & Santry Leeds - Otley Ireland t +353 (0) 1 294 0800 UK t +44 (0) 113 360 1720</p>	<p>Project Title:</p> <p>WEST CLARE RAILWAY GREENWAY SECTION 1: KILRUSH TO KILKEE</p>	<p>Drawing Title:</p> <p>PROPOSED GREENWAY LAYOUT SHEET 24 OF 45</p>								
				<p>ENVIRONMENTAL IMPACT ASSESSMENT REPORT</p>	<table border="1"> <tr> <td>Drawn: LA</td> <td>File:</td> <td>Status: E.I.A.R.</td> </tr> <tr> <td>Designed: MCR</td> <td>Job No: 21.121</td> <td></td> </tr> <tr> <td>Checked: DN</td> <td>Scale: 1:10,000</td> <td>Drawing No: Fig 4.25</td> </tr> <tr> <td>Approved: EOC</td> <td>Date: April 2026</td> <td>Rev: P0</td> </tr> </table>	Drawn: LA	File:	Status: E.I.A.R.	Designed: MCR	Job No: 21.121		Checked: DN	Scale: 1:10,000
Drawn: LA	File:	Status: E.I.A.R.											
Designed: MCR	Job No: 21.121												
Checked: DN	Scale: 1:10,000	Drawing No: Fig 4.25											
Approved: EOC	Date: April 2026	Rev: P0											

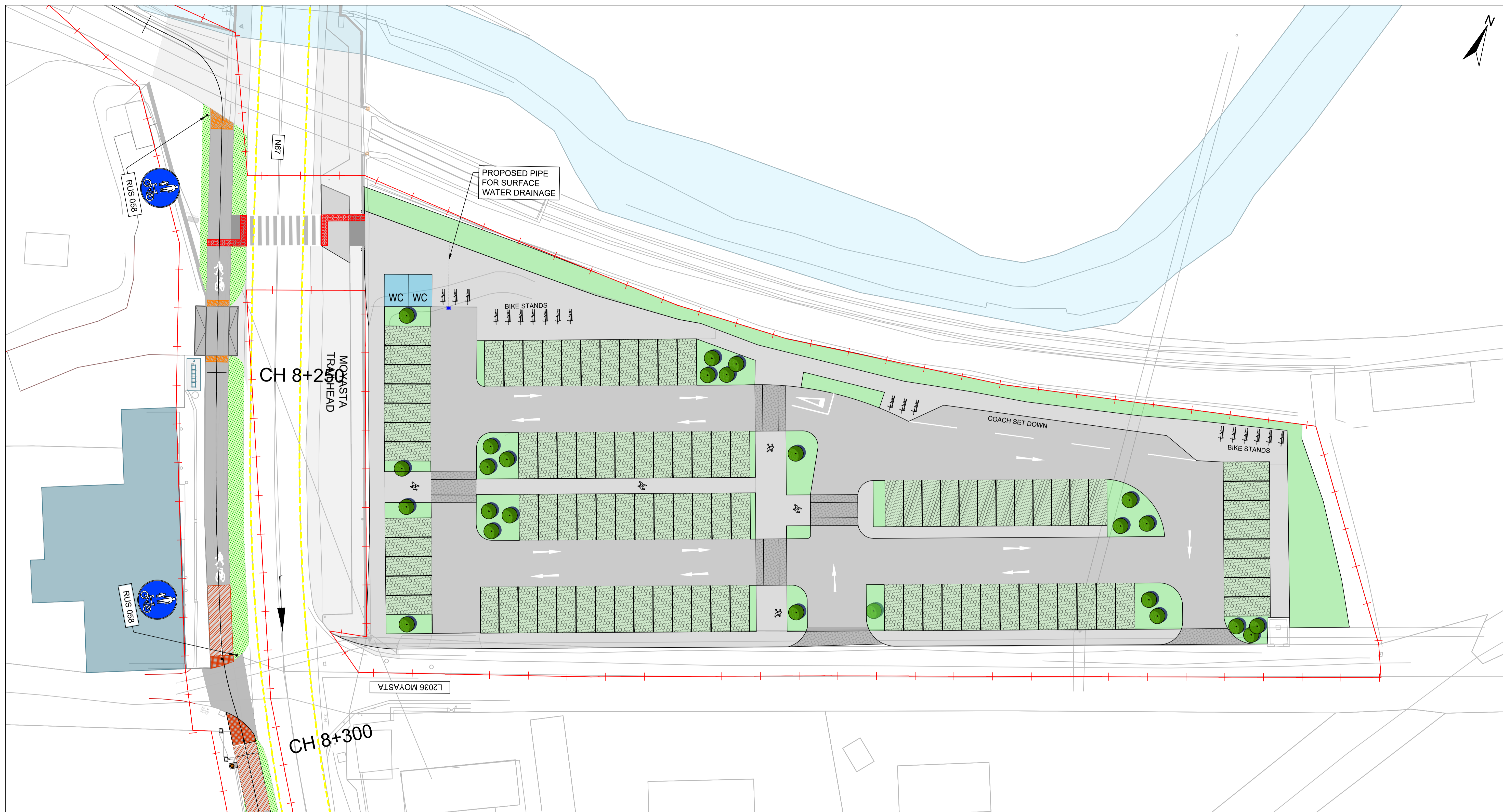

LEGEND:

	PROPOSED DEVELOPMENT		PROPOSED VERGE		EXISTING CULVERT & NEW PARAPETS
	FENCE		ACCESS TRACK		PROPOSED CULVERTS & PARAPETS
	GATE		WARNING SURFACE TREATMENT		WATERCOURSE/DRAINAGE DITCH
	BOLLARD		TACTILE BLISTERS		NEW / SUPPLEMENTARY PLANTING: (AS SET OUT IN CHAPTER 8 BIODIVERSITY)
	REFUSE BIN		EXISTING VEGETATION		
	PROPOSED GREENWAY PAVEMENT				



ROUGHAN & O'DONOVAN CONSULTING ENGINEERS

Offices:
 Dublin - Sandford & Santry
 Leeds - Otey
 Ireland t +353 (0) 1 294 0800
 UK t +44 (0) 113 360 1720

Project Title	WEST CLARE RAILWAY GREENWAY SECTION 1: KILRUSH TO KILKEE	
	ENVIRONMENTAL IMPACT ASSESSMENT REPORT	

Drawing Title: PROPOSED GREENWAY LAYOUT SHEET 25 OF 45			
Drawn: LA	File:	Status: E.I.A.R.	
Designed: MCR	Job No: 21.121		
Checked: DN	Scale: 1:10,000	Drawing No: Fig 4.26	Rev: P0
Approved: EOC	Date: April 2026		

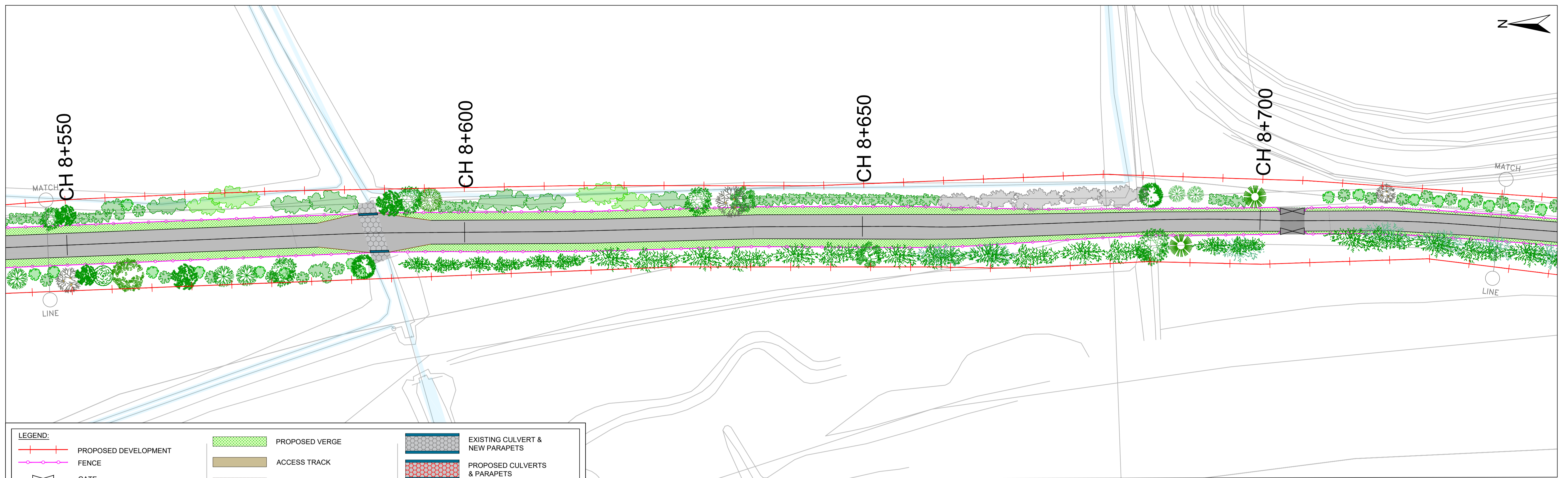

LEGEND:

	PROPOSED DEVELOPMENT		PROPOSED VERGE		EXISTING CULVERT & NEW PARAPETS
	FENCE		ACCESS TRACK		PROPOSED CULVERTS & PARAPETS
	GATE		WARNING SURFACE TREATMENT		WATERCOURSE/DRAINAGE DITCH
	BOLLARD		TACTILE BLISTERS		NEW / SUPPLEMENTARY PLANTING: (AS SET OUT IN CHAPTER 8 BIODIVERSITY)
	REFUSE BIN		EXISTING VEGETATION		
	PROPOSED GREENWAY PAVEMENT				



ROUGHAN & O'DONOVAN
CONSULTING ENGINEERS

Offices:
Dublin - Sandford & Santry
Leeds - Otley
Ireland t +353 (0) 1 294 0800
UK t +44 (0) 113 360 1720

Project Title	WEST CLARE RAILWAY GREENWAY SECTION 1: KILRUSH TO KILKEE	
	ENVIRONMENTAL IMPACT ASSESSMENT REPORT	

Drawing Title: PROPOSED GREENWAY LAYOUT SHEET 26 OF 45			
Drawn: LA	File:	Status: E.I.A.R.	
Designed: MCR	Job No: 21.121	Drawn No:	Rev: P0
Checked: DN	Scale: 1:10,000	Fig 4.27	
Approved: EOC	Date: April 2026		

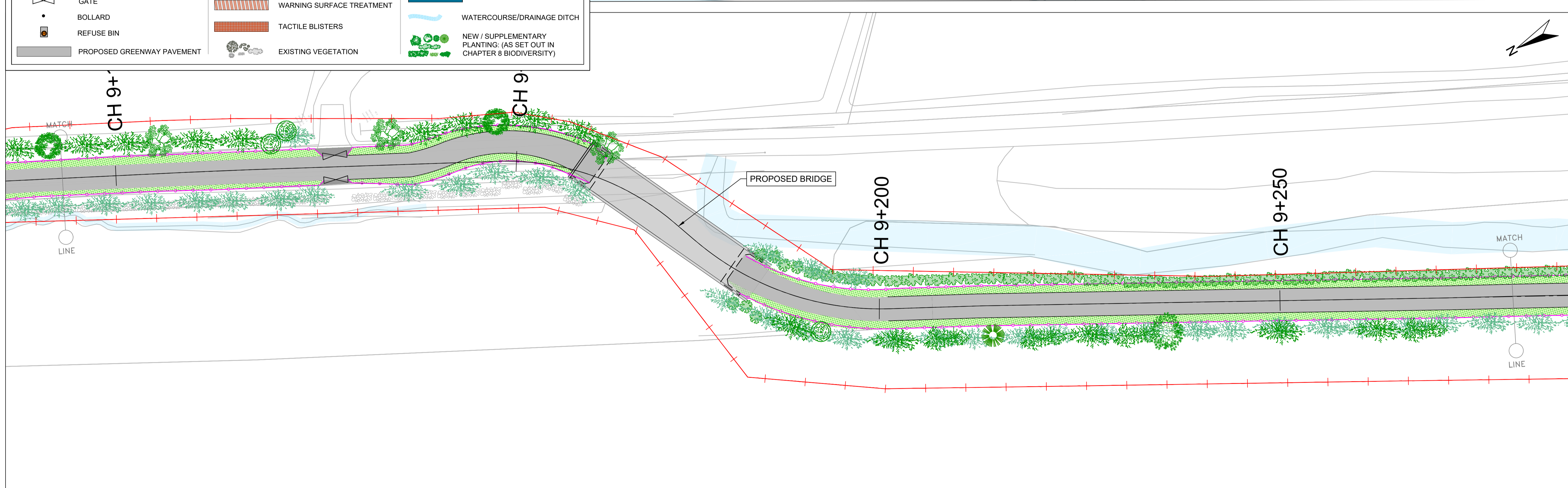
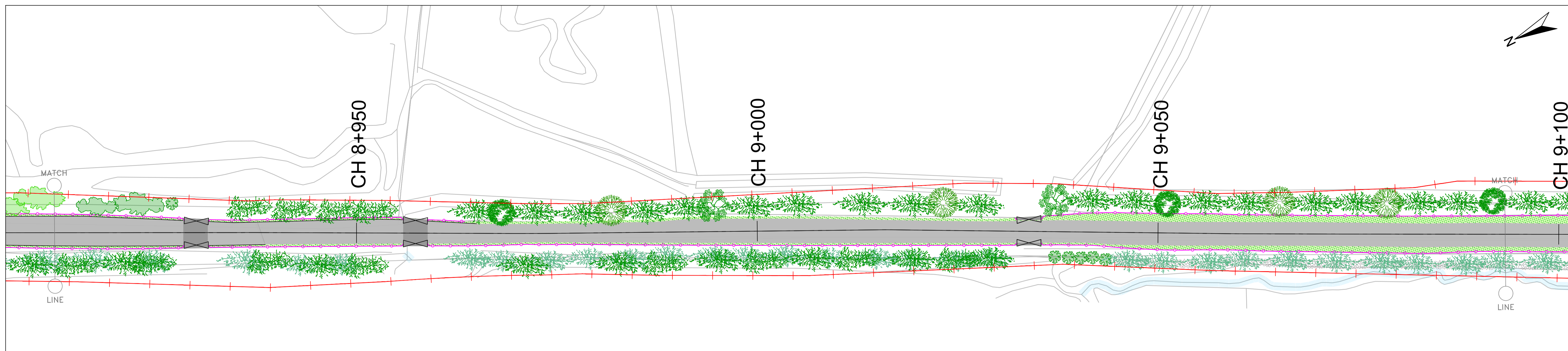

LEGEND:

	PROPOSED DEVELOPMENT		PROPOSED VERGE		EXISTING CULVERT & NEW PARAPETS
	FENCE		ACCESS TRACK		PROPOSED CULVERTS & PARAPETS
	GATE		WARNING SURFACE TREATMENT		WATERCOURSE/DRAINAGE DITCH
	BOLLARD		TACTILE BLISTERS		NEW / SUPPLEMENTARY PLANTING: (AS SET OUT IN CHAPTER 8 BIODIVERSITY)
	REFUSE BIN		EXISTING VEGETATION		
	PROPOSED GREENWAY PAVEMENT				



ROUGHAN & O'DONOVAN
CONSULTING ENGINEERS

Offices:
Dublin - Sandford & Santry
Leeds - Otey
Ireland t +353 (0) 1 294 0800
UK t +44 (0) 113 360 1720

Project Title	WEST CLARE RAILWAY GREENWAY SECTION 1: KILRUSH TO KILKEE	
	ENVIRONMENTAL IMPACT ASSESSMENT REPORT	

Drawing Title: PROPOSED GREENWAY LAYOUT SHEET 27 OF 45			
Drawn: LA	File:	Status: E.I.A.R.	
Designed: MCR	Job No: 21.121		
Checked: DN	Scale: 1:10,000	Drawing No: Fig 4.28	Rev: P0
Approved: EOC	Date: April 2026		

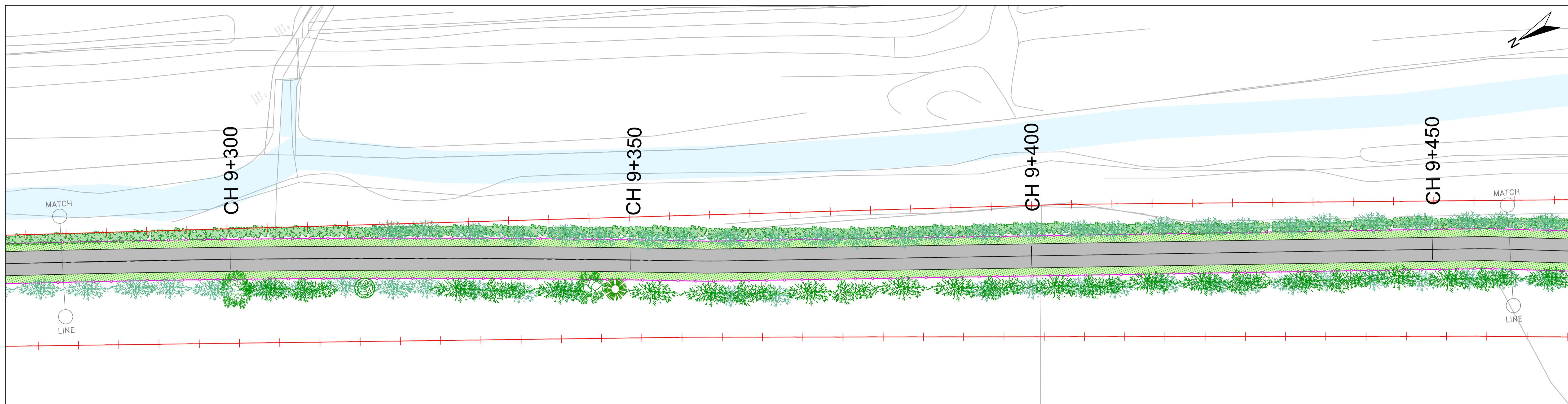

LEGEND:

PROPOSED DEVELOPMENT	PROPOSED VERGE	EXISTING CULVERT & NEW PARAPETS
FENCE	ACCESS TRACK	PROPOSED CULVERTS & PARAPETS
GATE	WARNING SURFACE TREATMENT	WATERCOURSE/DRAINAGE DITCH
BOLLARD	TACTILE BLISTERS	NEW / SUPPLEMENTARY PLANTING: (AS SET OUT IN CHAPTER 8 BIODIVERSITY)
REFUSE BIN	EXISTING VEGETATION	
PROPOSED GREENWAY PAVEMENT		



ROUGHAN & O'DONOVAN
CONSULTING ENGINEERS

Offices:
Dublin - Sandford & Santry
Leeds - Otley
Ireland t +353 (0) 1 294 0800
UK t +44 (0) 113 360 1720

Project Title:
**WEST CLARE RAILWAY GREENWAY
SECTION 1: KILRUSH TO KILKEE**

ENVIRONMENTAL IMPACT ASSESSMENT REPORT

Drawing Title: PROPOSED GREENWAY LAYOUT SHEET 28 OF 45			
Drawn: LA	File:	Status: E.I.A.R.	
Designed: MCR	Job No: 21.121	Drawing No: Fig 4.29	Rev: P0
Checked: DN	Scale: 1:10,000		
Approved: EOC	Date: April 2026		

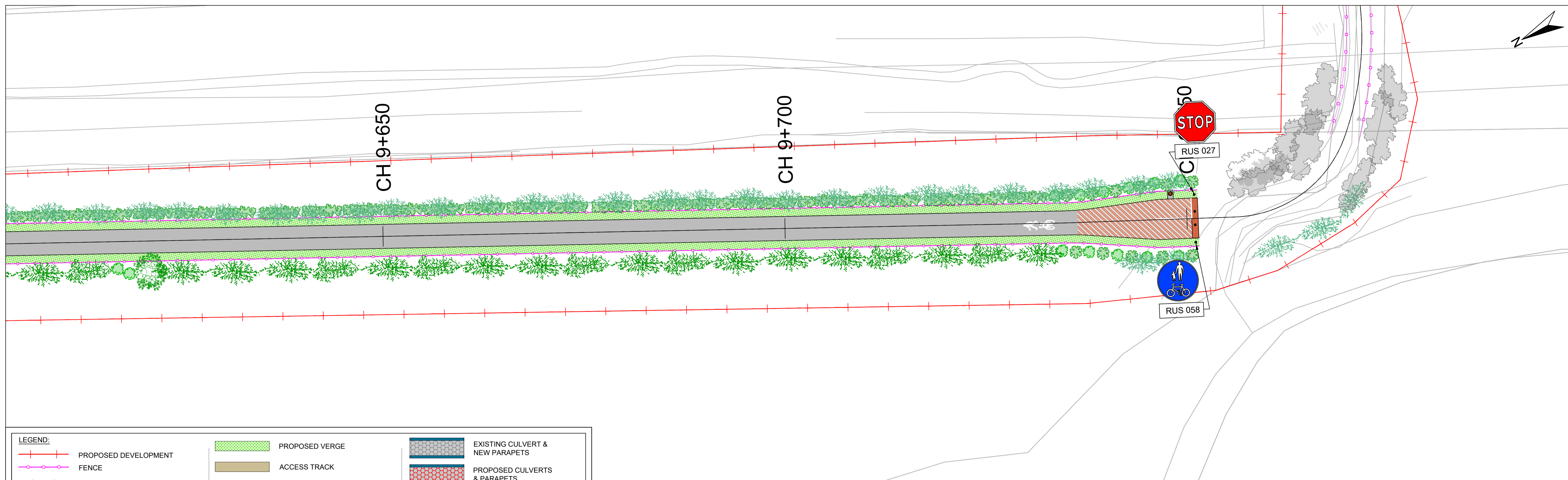

LEGEND:

	PROPOSED DEVELOPMENT		PROPOSED VERGE		EXISTING CULVERT & NEW PARAPETS
	FENCE		ACCESS TRACK		PROPOSED CULVERTS & PARAPETS
	GATE		WARNING SURFACE TREATMENT		WATERCOURSE/DRAINAGE DITCH
	BOLLARD		TACTILE BLISTERS		NEW / SUPPLEMENTARY PLANTING: (AS SET OUT IN CHAPTER 8 BIODIVERSITY)
	REFUSE BIN		EXISTING VEGETATION		
	PROPOSED GREENWAY PAVEMENT				

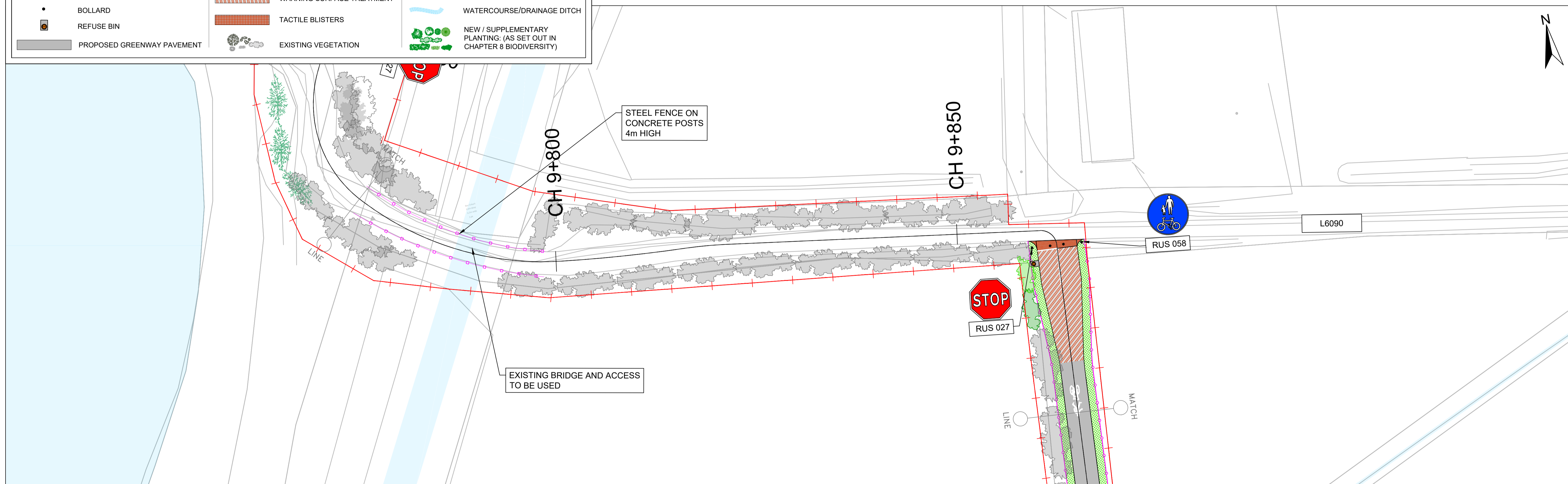

ROUGHAN & O'DONOVAN
CONSULTING ENGINEERS

Offices:
Dublin - Sandford & Santry
Leeds - Otley
Ireland t +353 (0) 1 294 0800
UK t +44 (0) 113 360 1720

Project Title:
WEST CLARE RAILWAY GREENWAY
SECTION 1: KILRUSH TO KILKEE

ENVIRONMENTAL IMPACT ASSESSMENT REPORT

Drawing Title:
PROPOSED GREENWAY LAYOUT
SHEET 29 OF 45

Drawn: LA	File:	Status: E.I.A.R.
Designed: MCR	Job No: 21.121	
Checked: DN	Scale: 1:10,000	Drawing No: Fig 4.30
Approved: EOC	Date: April 2026	Rev: P0